

SLC600-D Dimmer Switch

Quick Start Guide

Safety Handling

WARNING: Failure to follow these safety notices could result in fire, electric shock, other injuries, or damage to the Dimmer Switch and other property. Read all the safety notices below before using the Dimmer Switch.

- Avoid high humidity or extreme temperatures.
- Avoid long exposure to direct sunlight or strong ultraviolet light.
- Do not drop or expose the unit to intense vibration.
- Do not disassemble or try to repair the unit on your own.
- Do not expose the unit or its accessories to flammable liquids, gases or other explosives.

Technical Specifications

Wireless Connectivity

ZigBee	<ul style="list-style-type: none">• 2.4GHz IEEE 802.15.4
---------------	--

ZigBee Profile	<ul style="list-style-type: none">• ZigBee 3.0
-----------------------	--

RF Characteristics	<ul style="list-style-type: none">• Operating frequency: 2.4GHz• Internal PCB Antenna• Range outdoor/indoor: 100m/30m• TX Power: 19DB
---------------------------	--

Physical Specifications

Operating Voltage	<ul style="list-style-type: none">• 100~250 Vac 50/60 Hz
--------------------------	--

Flame Rating	<ul style="list-style-type: none">• V0
---------------------	--

Power consumption	<ul style="list-style-type: none">• < 1W
--------------------------	---

Operating environment	<ul style="list-style-type: none">• Indoor• Temperature: -20° C ~ +50° C• Humidity: ≤ 90% non-condensing
------------------------------	--

Dimensions	<ul style="list-style-type: none">• 86 Type Wire Junction Box• Product size: 92(L) x 92(W) x 35.4(H) mm• In-wall size: 63.3(L) x 61.9(W) x 22.4(D) mm• Thickness of front panel: 13mm
-------------------	--

Compatible system	<ul style="list-style-type: none"> • 3-wire Lighting Systems
Weight	<ul style="list-style-type: none"> • 145g
Mounting Type	<ul style="list-style-type: none"> • In-wall mounting • CN standard

1 Welcome

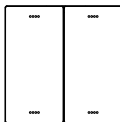

The Dimmer Switch SLC600-D is designed to control your device On/Off and adjust the brightness. You can bind it with multiple devices and control them at the same time.

This guide will provide you with an overview of the product and help you get through the initial setup.

Features:

- ZigBee 3.0 compliant
- Work with any standard ZigBee Hub
- Bind with multiple devices
- Control multiple devices at the same time

2 Installation

Important safety information!

- The Dimmer Switch must be installed and serviced only by qualified electrical personnel.
- Do not touch the terminals of the device during the testing.
- Turn off all power supplying this equipment before installing.
- Make sure that the power supply is off before connecting or disconnecting it to the auxiliary device.
- Always use a properly rated voltage sensing device to confirm power is off.
- Replace all devices, doors and covers before turning on power to this equipment.

Failure to follow these instructions will result in death or serious injury.

Get started:

- ① Turn off all power supplying and remove the switch panel.

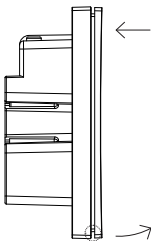

- ② Follow the wiring diagram for wiring

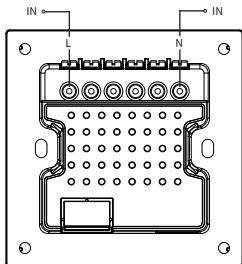

Wiring Diagram

- ③ Fix the switch to the wall with screws, close the panel

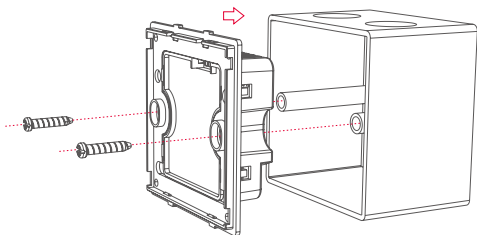

3 Get to know your device

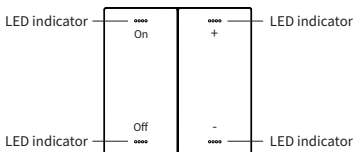

LED indicator

The LED status gives the following information:

LED status	What it means
Flashing slowly	Enable to join a ZigBee network.
When you press any button	
Flashing rapidly for 3 times	Device has not joined a ZigBee network.
Flashing rapidly for 1 time	Device has joined a ZigBee network/ Trigger the button.

Reset:

1. Press the On/Off button 4 times continuously, hold at the fourth time until the light starts to flash rapidly for 3 times.
2. Wait for a while, when the light turns flashing slowly, it means that the device has been reset to factory settings and enable to join a ZigBee network. It will automatically exit the mode after 90 seconds and the LED light will turn to steady.

4 Configure Network

4.1 To get started, you will need:

- A Zigbee Gateway.
- A mobile phone with a mobile APP installed.

4.2 Adding to the gateway's network

1. Set your gateway to permit joining (see your gateway's manual).
2. Power on the Dimmer Switch and make sure the LED indicator is flashing slowly (If not, reset it to factory defaults).
3. After few seconds the Dimmer Switch will join the gateway automatically and the LED indicator will become steady. Press any button to check if the LED status flashes rapidly for 1 times, which means it successfully joined.

Note: If the Dimmer Switch fails to join the gateway's network within 90 seconds, simply reset the Dimmer Switch and retry.

4.3 Pair the Dimmer Switch with other device

Note: Please make sure other device are also added into the same network of the gateway and can be controlled by the mobile app before you proceed.

1. Power your devices.
 2. Enable your device into identify mode. Your device will flash during the identify process.
 3. Place your device near to the Dimmer Switch, then press and hold the "+" or "-" button on the Dimmer Switch for 8 seconds until the LED indicator flashes rapidly for 3 times.
 4. Your bound device will stop flashing when pairing successfully.
- Tip: If pairing failed, you need to repeat the pairing and try again.

5. Now you are able to control your device by using the Dimmer Switch.

You can also follow the steps above to bind the Dimmer Switch with other dimmable devices. It supports up to 2 devices to pair.