

SLC600-L Lighting Switch

Quick Start Guide

Safety Handling

WARNING: Failure to follow these safety notices could result in fire, electric shock, other injuries, or damage to the Lighting Switch and other property. Read all the safety notices below before using the Lighting Switch.

- Avoid high humidity or extreme temperatures.
- Avoid long exposure to direct sunlight or strong ultraviolet light.
- Do not drop or expose the unit to intense vibration.
- Do not disassemble or try to repair the unit on your own.
- Do not expose the unit or its accessories to flammable liquids, gases or other explosives.

Technical Specifications

Wireless Connectivity

ZigBee	<ul style="list-style-type: none">• 2.4GHz IEEE 802.15.4
ZigBee Profile	<ul style="list-style-type: none">• ZigBee 3.0
RF Characteristics	<ul style="list-style-type: none">• Operating frequency: 2.4GHz• Range outdoor/indoor: 100m / 30m (Open area)• Internal PCB Antenna

Physical Specifications

Operating Voltage	<ul style="list-style-type: none">• 100~250 Vac 50/60 Hz
Max. Load Current	<ul style="list-style-type: none">• 10A (All gangs)
Operating environment	<ul style="list-style-type: none">• Temperature: -20° C ~ +50° C• Humidity: ≤ 90% non-condensing
Dimensions	<ul style="list-style-type: none">• 86 Type Wire Junction Box• Product size: 92(L) x 92(W) x 35.4(H) mm• In-wall size: 63.3(L) x 61.9(W) x 22.4(D) mm• Thickness of front panel: 13mm
Compatible system	<ul style="list-style-type: none">• 3-wire Lighting Systems
Weight	<ul style="list-style-type: none">• 145g
Mounting Type	<ul style="list-style-type: none">• In-wall mounting• CN standard

1 Welcome

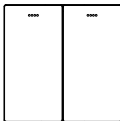

The Lighting Switch SLC600-L is designed to control your device On/Off remotely and schedule for automatic switching. Each gang can be controlled separately.

This guide will provide you with an overview of the product and help you get through the initial setup.

Features:

- ZigBee 3.0 compliant
- Remote on/off control
- Enables scheduling for automatic switching

2 Installation

Important safety information!

- The Lighting Switch must be installed and serviced only by qualified electrical personnel.
- Do not touch the terminals of the device during the testing.
- Turn off all power supplying this equipment before installing.
- Make sure that the power supply is off before connecting or disconnecting it to the auxiliary device.
- Always use a properly rated voltage sensing device to confirm power is off.

Failure to follow these instructions will result in death or serious injury.

Get started:

- ① Turn off all power supplying and remove the switch panel.

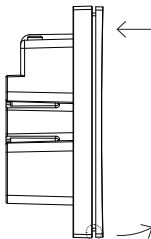

- ② Follow the wiring diagram for wiring

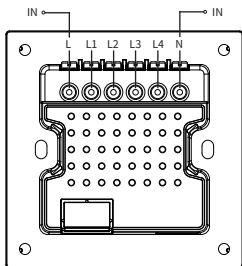

Wiring Diagram

*All lights shares the same Neutral wire

- ③ Fix the switch to the wall with screws, close the panel

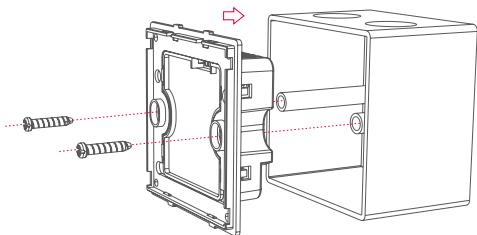

3 Get to know your device

L1 On/Off button & LED indicator

L2 On/Off button & LED indicator

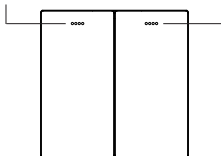

LED indicator

The LED status gives the following information:

LED status	What it means
Flashing slowly	Enable to join a ZigBee network.
Light On	The load is ON
Light Off	The load is OFF.
When you press any button	
Flashing rapidly for 3 times	Device has not joined a ZigBee network.
Flashing rapidly for 1 time	Device has joined a ZigBee network/ Trigger the button.

Reset:

1. Press one of the On/Off button for 4 times continuously, hold at the fourth time until the LED light flashes rapidly for 3 times.
2. Wait for a while, when the light turns flashing slowly, it means that the device has been reset to factory settings and enable to join a ZigBee network. It will automatically exit the mode after 90 seconds and the LED light will stop flashing.

4 Configure Network

4.1 To get started, you will need:

- A Zigbee Gateway.
- A mobile phone with a mobile APP installed.

4.2 Adding to the gateway's network

1. Set your gateway to permit joining (see your gateway's manual).
2. Power on the Lighting Switch and make sure the LED indicator is flashing slowly (If not, reset it to factory defaults).
3. After a few seconds the Lighting Switch will join the gateway automatically and the LED indicator will stop flashing. Press any button to check if the LED status flashes rapidly for 1 time, which means it has joined successfully.

Note: If the Lighting Switch failed to join the gateway's network within 90 seconds, simply reset the Lighting Switch and retry.

5 FAQ

Q 1. Can I control this switch using a wireless switch?

Yes. You could use a ZigBee wireless switch such as SLC602 wireless switch to control it rather than using the mobile app. You can refer to SLC602 guide to pair with it.