

SLC620 In-wall Mechanical Switch

Quick Start Guide

Safety Handling

WARNING: Failure to follow these safety notices could result in fire, electric shock, other injuries, or damage to the In-wall Machnic Switch and other property. Read all the safety notices below before using the In-wall Machanical Switch.

- Avoid high humidity or extreme temperatures.
- Avoid long exposure to direct sunlight or strong ultraviolet light.
- Do not drop or expose the unit to intense vibration.
- Do not disassemble or try to repair the unit yourself.
- Do not expose the unit or its accessories to flammable liquids, gases or other explosives.

Technical Specifications

Wireless Connectivity

ZigBee	<ul style="list-style-type: none">• 2.4GHz IEEE 802.15.4
ZigBee Profile	<ul style="list-style-type: none">• ZigBee HA1.2
RF Characteristics	<ul style="list-style-type: none">• Operating frequency: 2.4GHz• Range outdoor/indoor: 100m / 30m• Internal PCB antenna

Physical Specifications

Operating Voltage	<ul style="list-style-type: none">• 100~250 Vac 50/60 Hz
Operating environment	<ul style="list-style-type: none">• Temperature: -20°C ~ +50°C• Humidity: ≤ 90% non-condensing
Power consumption	<ul style="list-style-type: none">• < 0.5W
MAX. load current	<ul style="list-style-type: none">• 5 Amps/channel
Dimensions	<ul style="list-style-type: none">• Product size: 86(L) x 86(W) x 47(H) mm• In-wall size: 65(L) x 60(W) x 25(H) mm• Thickness of front panel: 10mm
Weight	<ul style="list-style-type: none">• 200g
Mounting Type	<ul style="list-style-type: none">• In-wall mounting• CN standard

1 Welcome

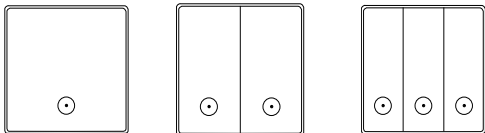

The SLC620 is a ZigBee in-wall Mechanical Switch that is used to switch your lights on/off using either the switch or mobile phone. Users could automate the lighting by setting schedules. This device is available in 1, 2, 3, 4 switch versions.

This guide will provide you with an overview of the product and help you get through the initial setup.

Features:

- ZigBee HA 1.2 compliant
- Remote on/off control
- Enables scheduling for automatic switching
- 1~4 channel on/off

2 Installation

Important safety information!

- The in-wall Mechanical Switch must be installed and serviced only by qualified electrical personnel.
- Do not touch the terminals of the device during the testing.
- Turn off all power supplying this equipment before installing.
- Make sure that the power supply is off before connecting or disconnecting it to the auxiliary device.
- Always use a properly rated voltage sensing device to confirm power is off.
- Replace all devices, doors and covers before turning on power to this equipment.

Failure to follow these instructions will result in death or serious injury.

Use a screwdriver with a straight tip to raise the front panel from ① ② as shown below:

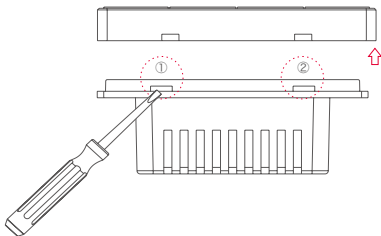

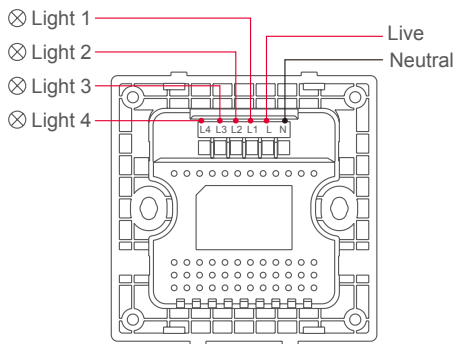

*All lights shares the same Neutral wire

Wiring Diagram

Attached the switch to the electrical box using the screws included in the box.

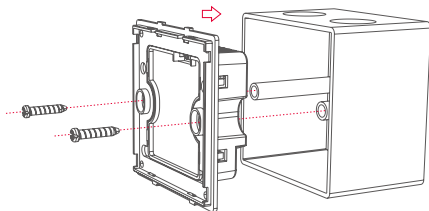

Firmly attach the front panel to the switch.

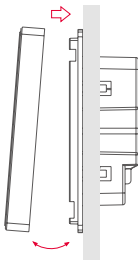

3 Get to know your device

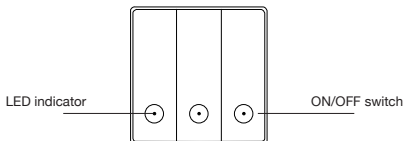

LED indicator

The LED status gives the following information:

LED status	What it means
Orange LED solid	Light(s) off
Blue LED solid	Light(s) on
Blue and Orange LED flashes alternatively twice	Enter pairing mode/joined a network

4 Configure Network

4.1 To get started, you will need:

- A Zigbee Gateway.
- A mobile phone with a mobile APP installed.

4.2 Adding to the gateway's network

1. Set your gateway to permit joining.
2. Press and hold one of the button(s) on the switch for 6 seconds until the LED indicator flashes twice in orange and blue alternatively, indicating it is ready to join the gateway's network.
3. The In-wall Mechanical Switch will join the gateway automatically. The LED indicator will flash twice in orange and blue alternatively again when successfully joined.
4. Now you can find the In-wall Mechanical Switch in the mobile app.