



# **SPF 2200-WB-TY**

## **Smart Pet Feeder**

---

Quick Start Guide



# Preface

Quick start by the following steps:

- Please scan the QR code on the packaging box or search '**Smartlife**' from APP store to download the APP.
- Make sure the device's Wi-Fi indicator is rapidly blinking. If not, please reset it.
- Keep close to the feeder, then open your bluetooth and App. The device will be automatically detected and showed in the App.
- Select '**Go to add**' to add automatically the Pet Feeder in "**Small Home Appliances**" list.

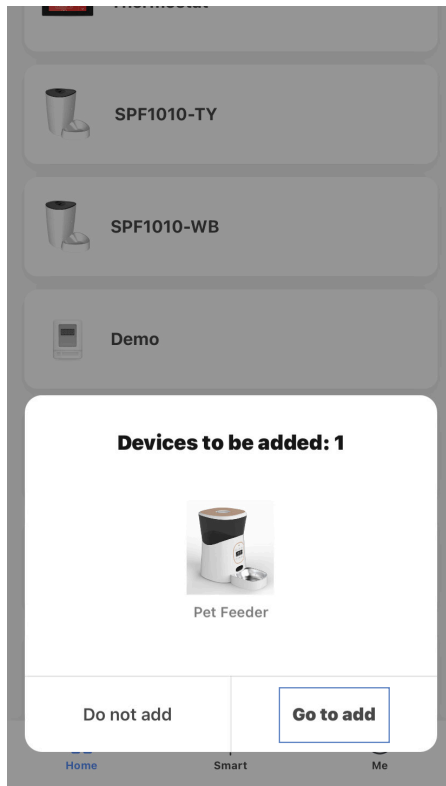

For more details about network pairing, please refer to chapter 4.

# Safety Notice

**WARNING:** Failure to follow these safety notices could result in fire, electric shock, other injuries, or damage to the Smart Pet Feeder and other property. Read all the safety notices below before using the Smart Pet Feeder.

- Avoid high humidity or extreme temperatures.
- Avoid long exposure to direct sunlight or strong ultraviolet light.
- Do not drop or expose the unit to intense vibration.
- Do not disassemble or try to repair the unit yourself.
- Do not expose the unit or its accessories to flammable liquids, gases or other explosives.

# Technical Specifications

---

<b>Hopper Capacity</b>	<ul style="list-style-type: none"><li>• 5 L</li></ul>
<b>Auto Feeding Time</b>	<ul style="list-style-type: none"><li>• 1-10 meals per day</li></ul>
<b>Power</b>	<ul style="list-style-type: none"><li>• DC power cord</li><li>• Backup batteries: 3 X D cell batteries (or 1 X 18650 type Li-ion battery)</li></ul>
<b>Buletooth</b>	<ul style="list-style-type: none"><li>• 4.2 Low energy</li></ul>
<b>Dimension</b>	<ul style="list-style-type: none"><li>• 383 x 221 x 338 mm</li></ul>
<b>N. W.</b>	<ul style="list-style-type: none"><li>• 1.55 kg</li></ul>
<b>Color</b>	<ul style="list-style-type: none"><li>• White</li></ul>

---

# 1 Welcome



The Smart Pet Feeder allows you to feed your pet remotely or apply schedules for automatic feeding. You can get the feeding information anywhere at any time.

This guide will provide you with an overview of the product and help you get through the initial setup.

## **Features:**

- Wi-Fi Remote control -Tuya APP smartphone programmable
- Dual feeding mode - Automatic & manual feeding
- Accurate feeding - Schedule up to feed 10 meals per day
- Recording and playback function - Recording will be played every time feeding
- Health Management- Record pet's daily feed quantity to track of their health
- Dual power protective - Battery backup, continuously operate when power off or internet disconnected

## 2 In the box

- Pet Feeder x 1
- Power Adapter x 1
- Quick Guide x 1

***NOTE: 18650 battery box needs to be purchased separately.***

Please check the condition and the accessories of pet feeder after you open the box.

### **APP Download:**

1. Scan the QR Code on the packaging box with your smartphone.
2. Search '**Smartlife**' APP from App store.

### **Tips:**

Dry and solid pet food only, recommended food diameter between 5 to 15 mm.

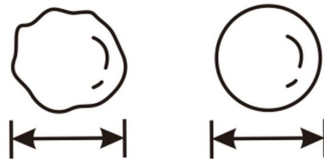

# 3

## Get to know your device

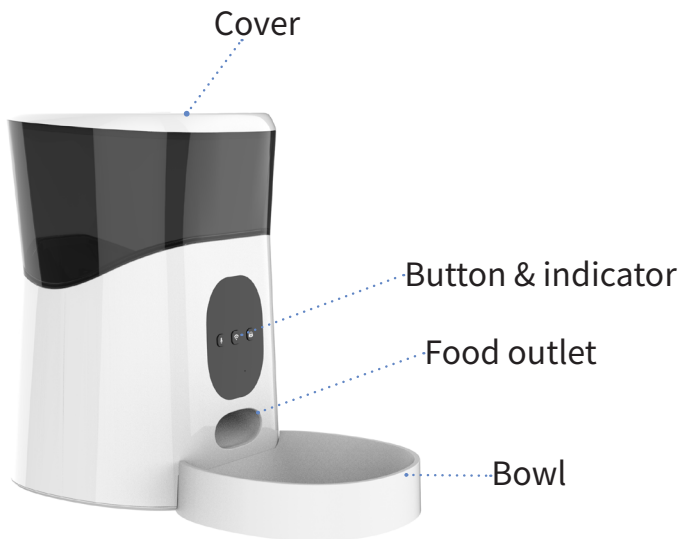



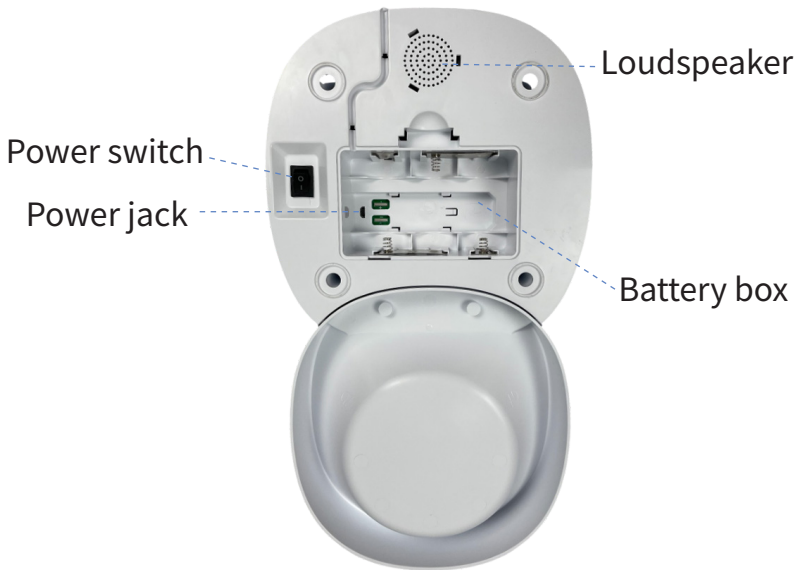

## Battery box

3 x D cell batteries ( or 1 x 18650 batteries ). Please pay attention to the polarity. Please note that the battery charging is for backup purpose only. If you wish to control the pet feeder remotely, power supply is needed.

***Note:** When the battery power is below 19%, the phone will receive a low battery alarm.*

## Power switch

— for ON, ○ for OFF.

## Power jack

Use the supplied power adapter.

## Loudspeaker

After the local recording is completed, the recording will be played every time the food is fed. Also you can set the number of times each recording can be played through the APP.

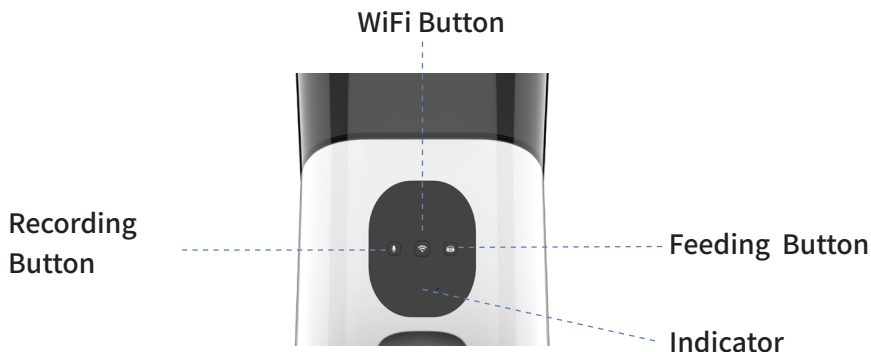

## Feeding Button:

- Short press to deliver a portion of food
- Long press to deliver food continuously

## Indicator

The Wi-Fi status gives the following information:

Wi-Fi Status	What it means
Blue light flashes rapidly	EZ pair mode.
Blue light flashes slowly	AP pair mode.
Blue light flashes steady	Pet Feeder has join the Internet.
Blue light off	Pet Feeder is disconnected.
Red light flashed rapidly	Food shortage alarm.
Red light flashes slowly	Food stuck alarm.
Green light flashes steady	Currently recording

- **EZ pair mode** (Default): Quick pair devices. You can set all devices to this mode, and then add devices in batches on your phone.
- **AP pair mode**: If you would like to pair one specific device during many devices. Please refer to Part 4 to configure network in this mode.

**Note:** The priority of light display will as following: Green light > Red light (Food stuck > Food shortage) > Blue light

## **Recording Button:**

- Long press the recording button to record. When the device indicator is green, the device is recording.

***Note:** Press and hold the button for 2 seconds to enter recording mode (the green light will be always on), and the recording ends when the hand is released. The longest recording time is 10 seconds.*

## **Audio playback:**

- Short press the recording button to play the recording.

# 4

## Get started

### To get started, you will need:

- Connect your phone to the 2.4Ghz Wi-Fi network.
- A mobile phone with a mobile APP installed.

### Then follow the steps below:

1. Power on the Smart Pet Feeder.
2. Make sure the Wi-Fi indicator is rapidly blinking. If not, please reset it.

## 4.1 Add devices

1. Open your App.
2. Login with an existing account. If you are a new user, you need to create an account at first.
3. Turn on **"Bluetooth"** and **"Location"** on your phone before connecting the Wi-Fi.

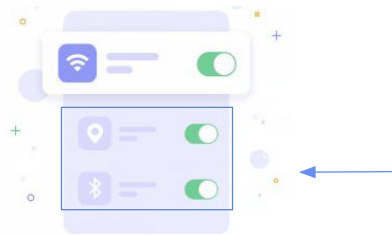

4. Once login, the phone will automatically detect the device via Bluetooth. And choose "Go to add".

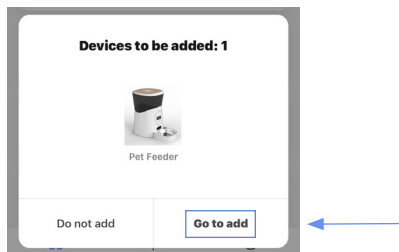

5. Enter your home Wi-Fi account and password (Only support 2.4Ghz Wi-Fi), then tap **"Next"** button.

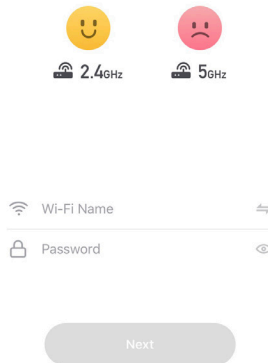

## Other Device Adding Mode

### 1. Configure the network in EZ mode.

**Note:** In this case, if you only need to configure one device, no need to turn on your phone's bluetooth.

1.1 Please click the '+' button at the top right corner of the App to add devices.

1.2 Select '**Pet Feeder**' to add manually the Pet Feeder in "**Small Home Appliances**" list.

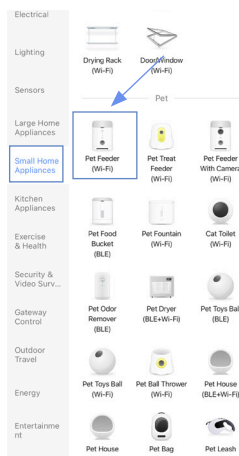

1.3 Enter your home Wi-Fi account and password (Only support 2.4Ghz Wi-Fi), then tap "**Next**" button.

1.4 Place the router, mobile phone, and Pet Feeder as close as possible. Confirm the indicator on your device is rapidly blink, then tap "**Next**" to wait for connection.

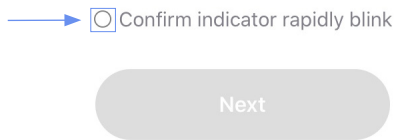

## 2 Configure the network in AP mode.

**Note:** In this case, no need to turn on your phone's bluetooth.

2.1 Reset the device in EZ pair mode, it will switch to AP pair mode. The indicator on your device will blink slowly.

2.2 Then switch the network configuration mode to AP mode at the upper right corner of the APP when you add the device.

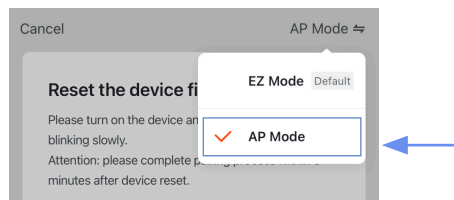

2.3 Place the router, mobile phone and Pet Feeder as close as possible. Confirm the indicator on your device is slowly blink, then tap "**Next**" to wait for connection.

## Connect your mobile phone to the device's hotspot

1. Connect the phone to the hotspot shown below.

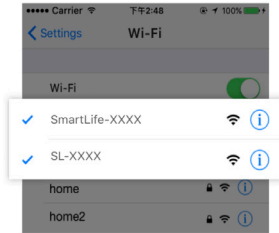

2. Go back to the app and continue to add devices.

2.4 After the device has been added, you can use  to rename the device. (If failed, please refer to FAQ2 to troubleshoot)

## 6. Wi-Fi configuration of the device failed

- Confirm the entered router password is correct.
- Ensure that the DHCP service is enabled for the router. If not, the IP address will be occupied.
- Please confirm the Wi-Fi network is stable:

Put the phone besides your device and make sure they are in the same network environment, try to open a website to judge if the network can be used.

- If your router supports both 2.4Ghz and 5Ghz, please enable the 2.4Ghz channel and add device under 2.4G Wi-Fi channel. You can follow the following step on the App to configure the router.

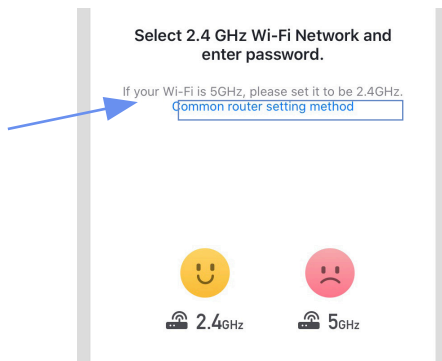

- Confirm that both the location permission of phone system and the App are enabled.

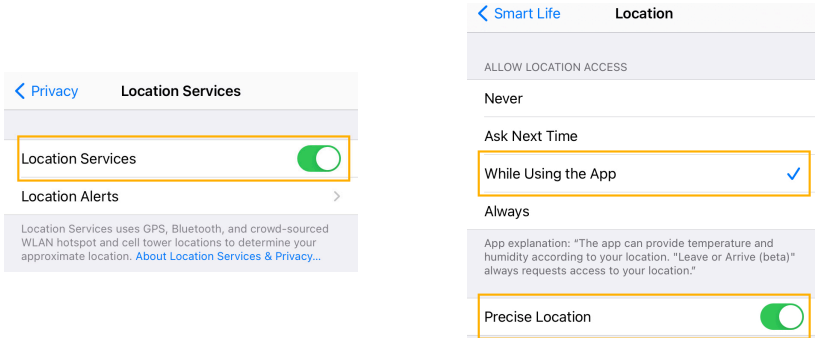

- If you have already upgrade the iOS system to 14, you need to enable the "Local network" and "Bluetooth" of the App.

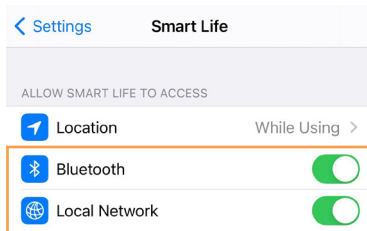

- If it still does not work, it is recommended to change the router and try again.

## 7. Device offline

- Confirm whether the Pet Feeder is powered on.
- Please confirm whether the home Wi-Fi network is normal, or whether the Wi-Fi name and password has been modified.
- If there still have problems after the above checking, it is recommended to remove the device or change the router to add it again.



8. Place the router, mobile phone, and pet feeder as close as possible. Confirm the indicator on your device is rapidly blink, then tap "**Next**" to wait for connection.

→  Confirm indicator rapidly blink

Next

9. After the device has been added, you can use  to rename the device. (If failed, please repeat above steps.)

# 4.2 App Overview:

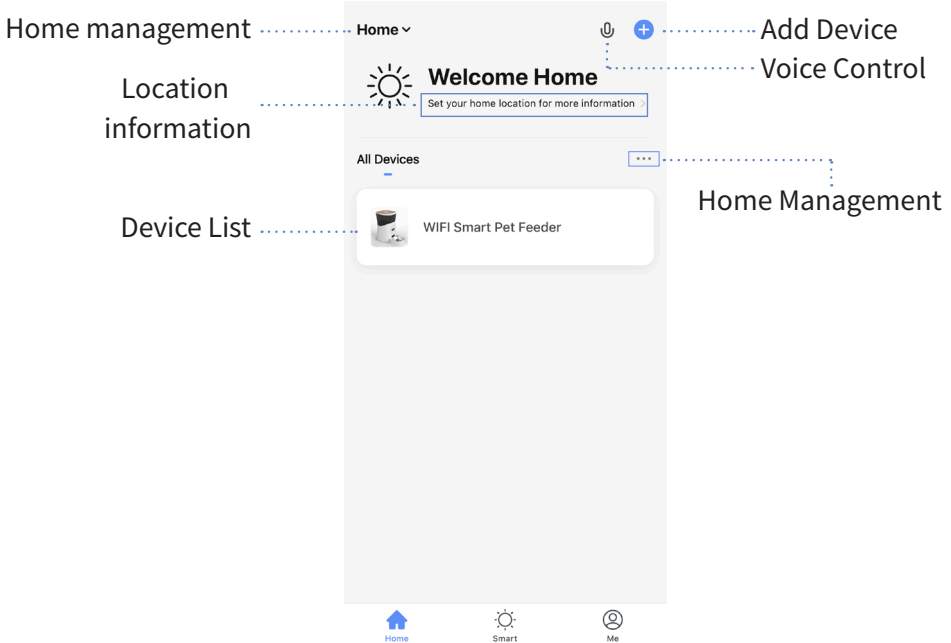

## Home:

### 1.Home management

Add or delete home and manage home names, rooms, locations, and members.

### 2.Location information

Information about your local weather, conditions, outdoor temperature,PM.

### 3.Device list

You can check the added device, tap one to enter control board.

### 4.Add devices

You can add other other devices directly from it.

### 5.Management

You can change device's display mode, manage device, create rooms and assign devices to each room.

### 6.Voice control (Available with Google Voice)

**Smart:** Create smart scene and add automatic function

**Me:** App settings and FAQ about the app

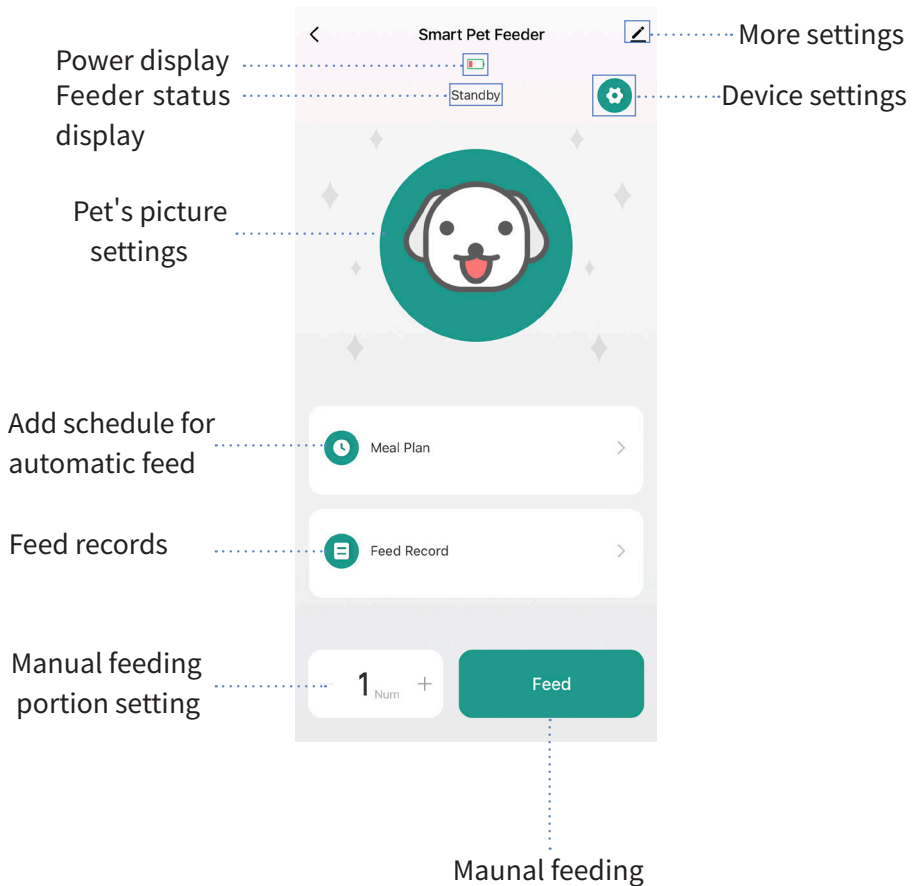

## 1. Control board:

Select the target Pet Feeder in device list then enter the control board

- Meal plan

Tap to edit the schedule for the automatic feed. Schedule supports up to 10 items and per schedule supports up to 12 portions. The error of the schedule is about 30 seconds.

- Feed record

Tap to check the feeding history.

- Manual feeding & Feeding portion setting  
Tap "-" to reduce feeding portion and tap "+" to add feeding portion when manual feeding. The maximum number of portion is 12 at a time.
- Feeder status display  
It will have three different status: Standby, Feeding and Done.
- Pet's picture setting  
Tap to set or change the pictures of your pet.
- More settings  
Tap for more settings, like rename device, device information, third-party control and others.
- Device setting  
Tap to set the number of voice playbacks, indicator lights, clear recordings, restore factory settings, etc.

## 2. Food stuck alarm:

When the food is stuck, the APP will receive the alarm. And the red light will flash slowly.

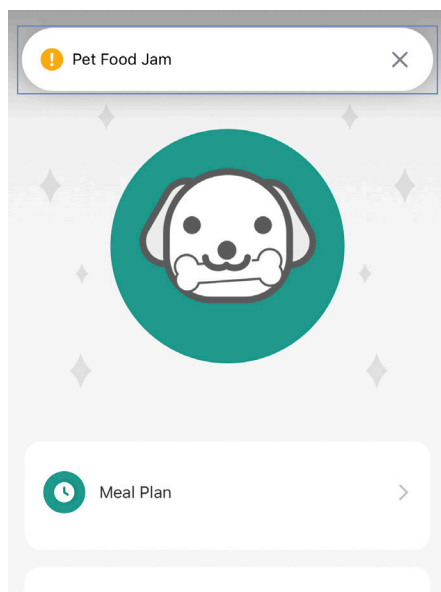

### 3. Food shortage alarm:

When it is short of pet food, the APP will receive the alarm. And the red light will flash rapidly.

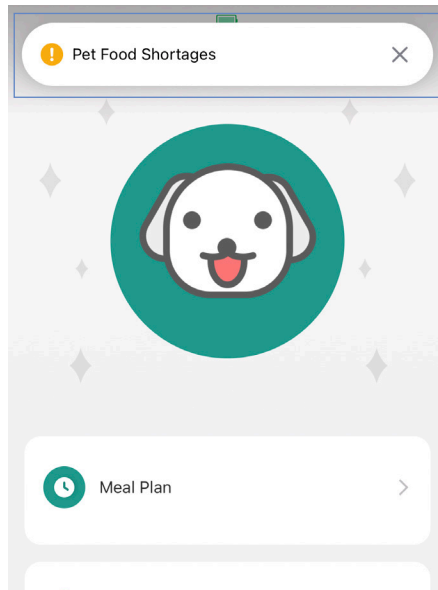

### 4. Feeding plan display:

The next feeding time and the number of portions will be shown.

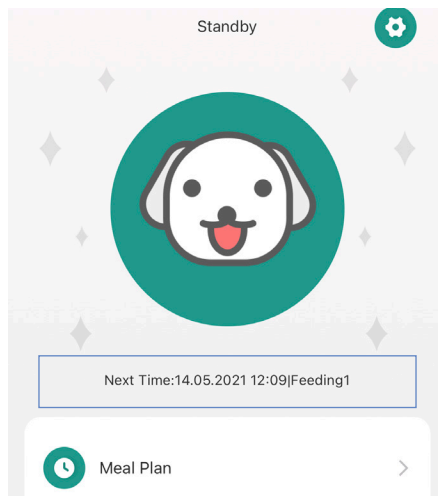

## 5. FAQ:

### How to install the 18650 battery:

**Note:** Both the battery and the battery box of 18650 need to be purchased separately

1. Get a battery box with 18650 battery, like figure 1.
2. Place the feeder horizontally in front of the body, then put the battery box into the battery slot according to the direction shown in the figure 2, and then push it forward to fix it.



Figure 1

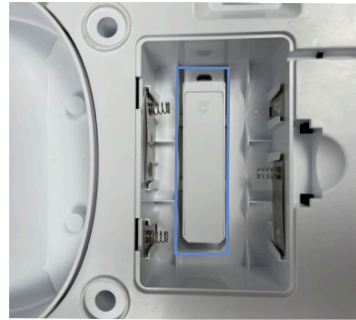

Figure 2