



SPF2000-V-TY Smart Pet Feeder

Quick Start Guide

Safety Notice

WARNING: Failure to follow these safety notices could result in fire, electric shock, other injuries, or damage to the Smart Pet Feeder and other property. Read all the safety notices below before using the Smart Pet Feeder.

- Avoid high humidity or extreme temperatures.
- Avoid long exposure to direct sunlight or strong ultraviolet light.
- Do not drop or expose the unit to intense vibration.
- Do not disassemble or try to repair the unit yourself.
- Do not expose the unit or its accessories to flammable liquids, gases or other explosives.

Technical Specifications

Hopper Capacity	• 7.5L
Auto Feeding Time	• 1-8 meals per day
Microphone	• 10 meters, -30dBV/Pa
Speaker	• 8 Ohm 1w
Battery	• 3 x D cell batteries or DC power cord
Dimension	• 230 x 230 x 500 mm
N. W.	• 3.76 kgs
Color	• Whites

1 Welcome



The Smart Pet Feeder allows you to feed remotely or apply schedules for automatic feeding. With HD camera, you can even interact with your pets using voice from your mobile phone when you're not home.

This guide will provide you with an overview of the product and help you get through the initial setup.

Features:

- Wi-Fi Remote control -Tuya APP smartphone programmable.
- HD camera - real time interaction
- Camera recording & playback
- Automatic & manual feeding -built in display and buttons for manual control and programming
- Accurate feeding -Schedule up to 8 feeds per day
- Voice interaction through the feeder
- 7.5L food capacity -7.5L large capacity
- Key lock -Prevent mis-operation by pets or kids
- Dual power protective -Battery backup, continuous operation during power or internet failure

2 In the box

- **Pet Feeder x 1**
- **Power Adapter x 1**
- **Quick Guide x 1**
- **Cord Hose Protector x 1**
- **Stand x 1**

After opening the product packaging, please confirm the Pet Feeder is in good condition and the accessories are complete.

APP Download:

Scan the QR Code behind the Pet Feeder with your smartphone.

Tips:

1. Please load the backup batteries to ensure consistent working during power outage.
2. Recommend food size between 5 mm – 15 mm.

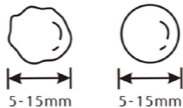

3

Get to know your device



Wi-Fi indicator

The Wi-Fi status gives the following information:

Wi-Fi Status	What it means
Flashing	Pet Feeder has not join the Internet.
Steady light	Pet Feeder has join the Internet.

Fault indicator lamp

The Fault indicator flashes when one of the following happens:

- Network situation: the Pet Feeder cannot connect to the cloud
- Gate situation: the gate is jammed
- Feeding situation: there is no food come out, or food doesn't come out right

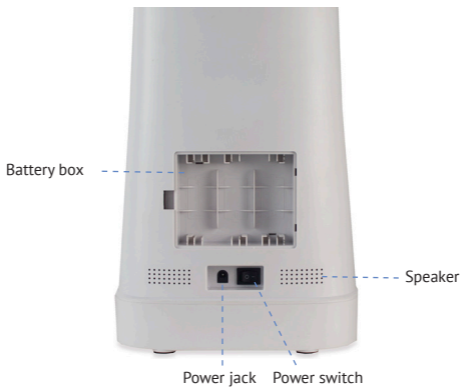

Battery box

3 x D-size batteries. Please pay attention to the polarity. Please note that the battery charging is for backup purpose only. If you wish to control the pet feeder remotely, power supply is needed.

Speaker

Output the sound.

Power switch

— for ON, ○ for OFF.

Power jack

Use the supplied power adapter.

Button Introduction:



Lock.

Hold the button for 6 seconds then release it to lock all buttons. Hold it again for 6 seconds then release it to unlock.



Reset network configuration.

Hold the button for 6 seconds then release it. After beep sound and the start-up sound, the network configuration will be reset.



Feed.

Manually feed once in 3 portions.



SET.

Enter/exit to set-up status.



UP.

Increase menu value. Hold the button, you can increase quickly.



OK.

Confirm current setting and move to next setting.

Display Introduction:

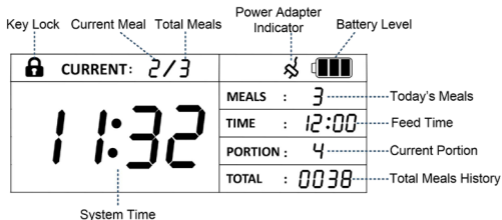

Setup manually

• Setup system time

1. Press 'SET', the Hour of system time starts flashing, press 'UP' to set the hour, and then press 'OK' to confirm.
2. The Minute of system time starts flashing, press 'UP' to set the minute, and then press 'OK' to confirm. After that, you can setup automatic feeding.

• Setup automatic feeding

3. After system time's setup, the 'MEALS' starts flashing, press 'UP' to setup meals, and then press 'OK' to confirm.
4. Then 'CURRENT' starts flashing, you can setup time and portion of each meal one by one. The setting order is 'CURRENT' -> 'TIME' -> 'PORTION', and then move to the next meal. After setting all the meals, the set-up status will exit.

4

Get started

To get started, you will need:

- A Wi-Fi network.
- A mobile phone with a mobile APP installed.

Then follow the steps below:

1. Power on the Smart Pet Feeder.
2. Make sure the Wi-Fi indicator lamp is flashing. If not, please reset the network configuration.

4.1 Add devices

1. Open your App
2. Login with existing account, if you are a new user you need to create an account at first
3. Please click the '+' button at the top right corner of the App to add devices
4. Select '**Smart Camera**' to add manually the Pet Feeder in "**Security & Sensors**" list



5. Confirm your Wi-Fi indicator is rapidly blinking. Then enter your home Wi-Fi account and password (Only support 2.4GHz Wi-Fi), tap '**Confirm**' button

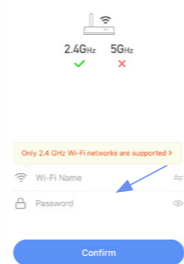

6. Tap '**Continue**' to scan QR code on your mobile phone.

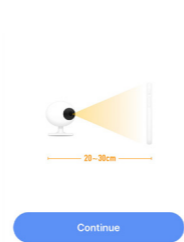

7. Place the QR code in front of the feeder's camera to scan at a distance of 15cm to 20cm. There will be a prompt sound when the scan is successful. Tap '**I heard a prompt**' to continue.

8.Place the router, mobile phone and Pet Feeder as close as possible

9.Waiting for connection



Device found
Register Device to Smart Cloud
Initializing device...

10.After the device has been added, you can use  to rename the device and tap '**Done**' to enter the control interface.

4.2 App Overview:

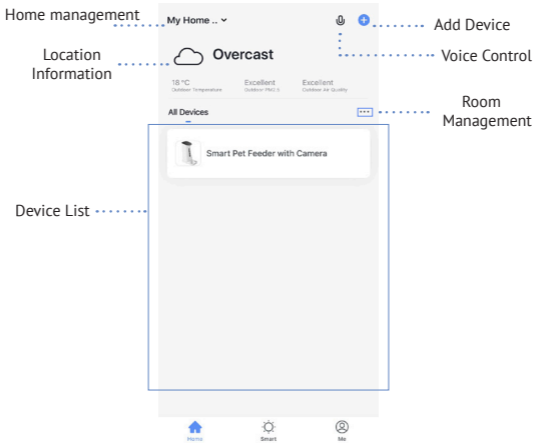

Home:

1. Device list

You can check the added device, tap one to enter control board

2. Location information

Information about your local weather conditions, outdoor temperature, PM

3. Home management

Add or delete home and manage home names, rooms, locations, and members

4. Room management

Manage room. You can create rooms and assign devices to each room

5. Voice control (Temporarily not available on App)

Smart: Create smart scene and add automatic function (Temporarily not available)

Me: App settings and FAQ about the app

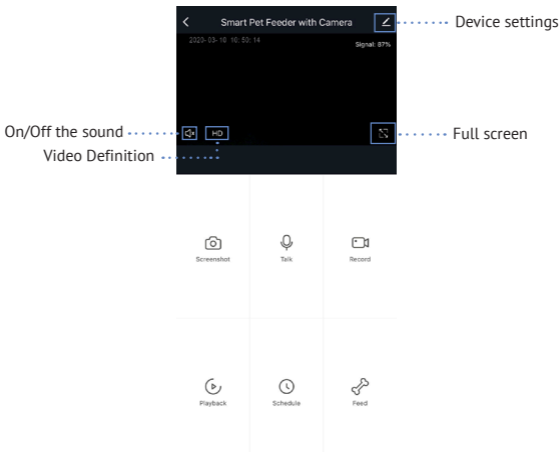

Control board:

Select the target Pet Feeder in device list then enter the control board

- Screenshot

Press to save the current image of camera to the phone's photo gallery

- Talk

Press it to talk through the Feeder. There have 2 modes for you to choose, "Two-way Talk" and "One-way Communication", you can change the it under '**Device settings**' -> '**Basic Function Settings**' -> '**Talk Mode**'

- Record

Press to save the current video of camera to the phone's photo gallery. If you turn off the sound, you will record a silent video

- Playback
Playback your record video on your SD card
- Schedule
Program time periods, cycle and portion to feed automatically. Timer tolerance may be about +/- 30 seconds. It supports up to 8 schedules can be set.
- Feed
Set portion to feed manually once
- Alarm
Enable motion detection to get notification on your mobile when something move within the camera's field

5 FAQ

1.How do I install the stand

First, take the black gasket off at the bottom. Then align the stand with the hole at the bottom. Gently push the stand into the hole at the bottom.

2.Where should the TF card be installed

Open the cover and remove the food storage bucket. There is a slot inside the Pet Feeder. That is the TF card slot, you can install the TF card into it.

