



SPF2200-V-TY Smart Pet Feeder

Quick Start Guide

Safety Notice

WARNING: Failure to follow these safety notices could result in fire, electric shock, other injuries, or damage to the Smart Pet Feeder and other property. Read all the safety notices below before using the Smart Pet Feeder.

- Avoid high humidity or extreme temperatures.
- Avoid long exposure to direct sunlight or strong ultraviolet light.
- Do not drop or expose the unit to intense vibration.
- Do not disassemble or try to repair the unit yourself.
- Do not expose the unit or its accessories to flammable liquids, gases or other explosives.

Technical Specifications

Hopper Capacity	• 5 L
Auto Feeding Time	• 1-10 meals per day
Power	• DC power cord • Backup batteries: 3 X D cell batteries (or 1 X 18650 type Li-ion battery)
Camera Resolution	• 1920 x1080
Buletooth	• BLE 4.2
Dimension	• 221(L) x 383(W) x 338(H) mm
N. W.	• 1.55 kg
Power Consumption	• 1.7 W
Color	• White

1 Welcome



The Smart Pet Feeder allows you to feed remotely or apply schedules for automatic feeding. With the voice recording function, you can even interact with your pets using voice from your mobile phone when you're not home.

This guide will provide you with an overview of the product and help you get through the initial setup.

Features:

- Wi-Fi Remote control -Tuya APP smartphone programmable.
- HD camera - real time interaction
- Camera recording & playback
- Automatic & manual feeding
- Accurate feeding -Schedule up to 8 feeds per day
- Voice interaction through the feeder
- Dual power protective -Battery backup, continuous operation during power or internet failure

2 In the box

- **Pet Feeder x 1**
- **Power Adapter x 1**
- **Quick Guide x 1**
- **Cord Hose Protector x 1**

Please check the condition and the accessories of pet feeder after you open the box.

APP Download:

1. Scan the QR Code behind the Pet Feeder with your smartphone.
2. Search '**Smartlife**' APP from App store.

Tips:

Recommend food size between 5 mm – 15 mm.

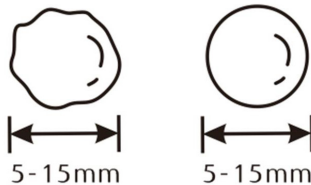

3

Get to know your device

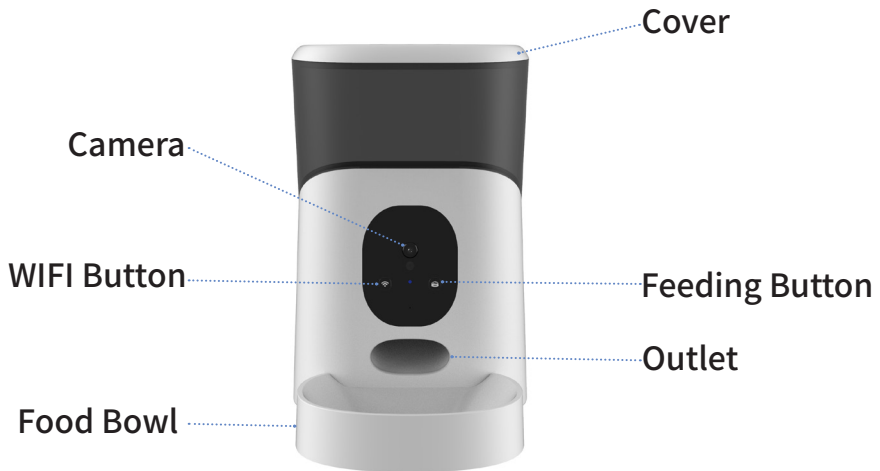

Indicator

The indicator statu gives the following information:

Indicator Status	What it means
Blue light flashes slowly	The device is being connected to the network or is offline.
Blue light normally on	Device has connected to the cloud.
Red light flashes rapidly	Food stuck/Low battery
Red light flashes slowly	Food shortage
Green light flashes slowly	Only powered by batteries

Note: The device will be disconnected automatically when the battery is powered, and the camera function is unavailable!

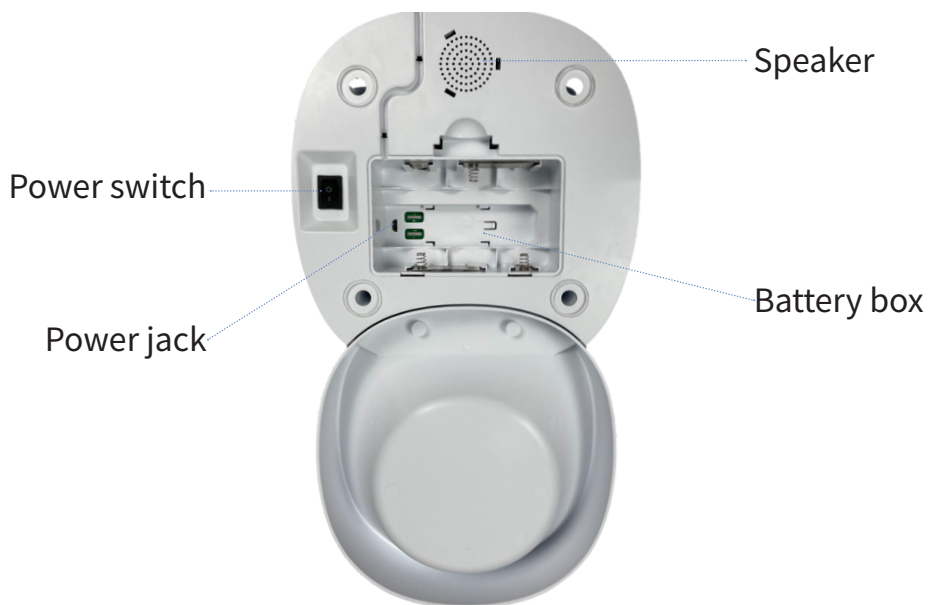

Battery box

3 x D-size batteries (or 1 x 18650 Li-ion). Please pay attention to the polarity. Please note that the battery charging is for backup purpose only. If you wish to control the pet feeder remotely, power supply is needed.

Speaker

Play sound.

Power switch

— for ON, ○ for OFF.

Power jack

Use the supplied power adapter.

Feeding Button

Short press: Supply one portion (1 portion=15g)

Long Press: Supply food continuously

Wi-Fi Button

Hold down the button for 5 seconds and release it. After hearing a beep, wait for the device to restart automatically. When the blue indicator blinks slowly, the network is reset and enters the configuration state; when the blue indicator flashes rapidly, the network resetting successfully.

4

Get started

To get started, you will need:

1. A Wi-Fi network.
2. A mobile phone with a mobile APP installed.

Then follow the steps below:

1. Power on the Smart Pet Feeder.
2. Make sure the blue LED is rapidly blinking. If not, please refer to Chapter 3, Wi-Fi button instruction to reset the network configuration.

4.1 Add devices

1. Open your App
2. Login with an existing account. If you are a new user, you need to create an account at first
3. Please click the '+' button at the top right corner of the App to add devices
4. Select '**Smart Camera**' in "**Security&Sensors**" list to add manually the Pet Feeder

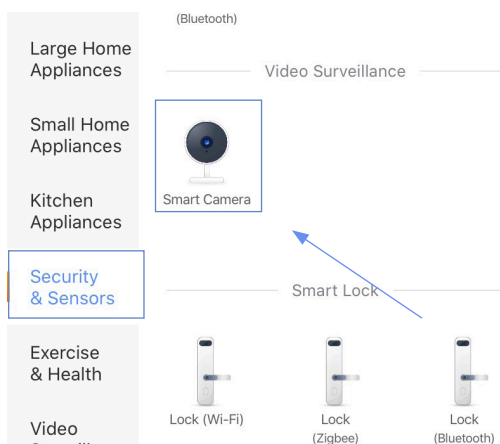

5. Confirm your Wi-Fi indicator is rapidly blinking. Then enter your home Wi-Fi account and password(Only support 2.4Ghz Wi-Fi)

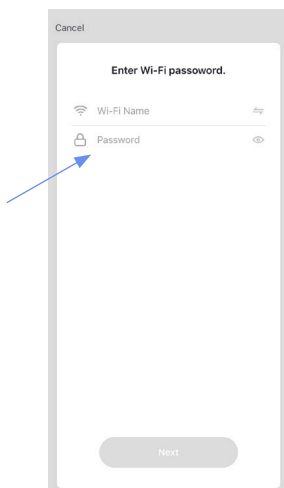



6. Tap '**Continue**' to scan QR code on your mobile phone.

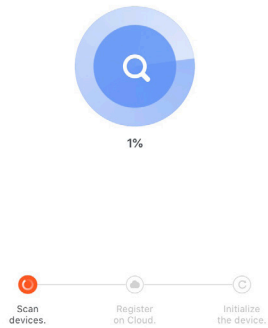

7. Place the QR code in front of the feeder's camera to scan at a distance of 15cm to 20cm. There will be a prompt sound when the scan is successful. Tap '**I heard a prompt**' to continue.

8. Place the router, mobile phone, and Pet Feeder as close as possible
9. Waiting for connection



10. After the device has been added, you can use  to rename the device.

4.2 App Overview:

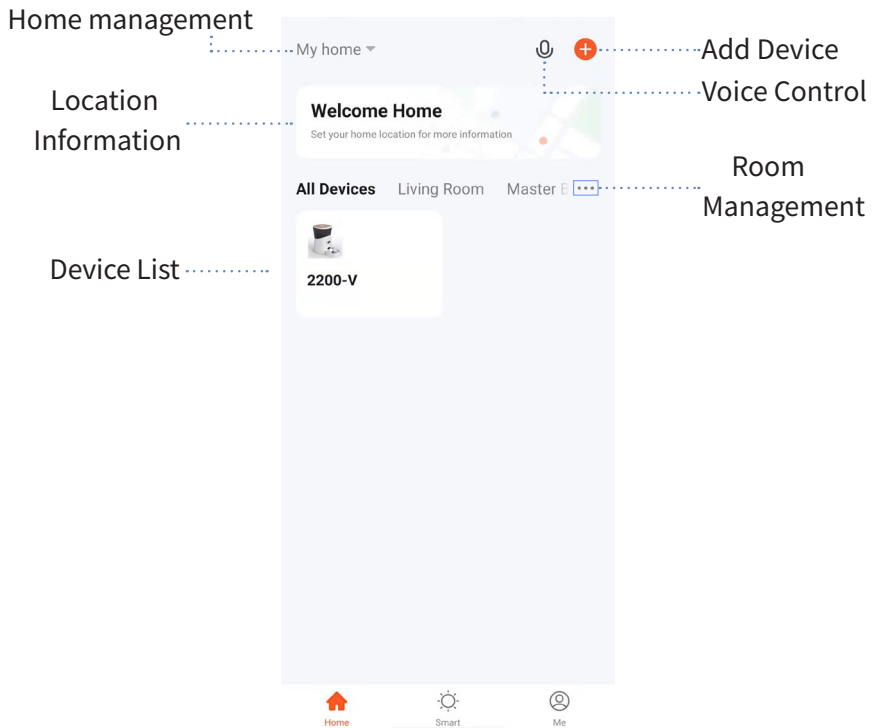

Home:

1. Device list

You can check the added device, tap one to enter control board

2. Location information

Information about your local weather conditions, outdoor temperature, PM

3. Home management

Add or delete home and manage home names, rooms, locations, and members

4. Room management

Manage room. You can create rooms and assign devices to each room

5. Voice control (Temporarily not available on App)

Smart: Create smart scene and add automatic function (Temporarily not available)

Me: App settings and FAQ about the app

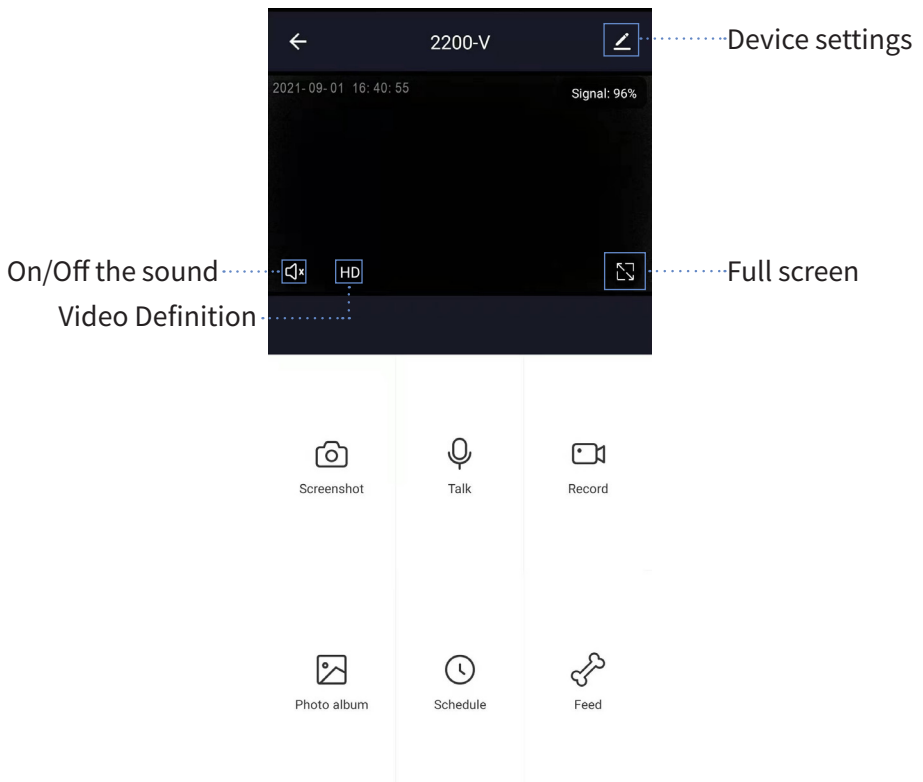

Control board:

Select the target Pet Feeder in device list then enter the control board

- Screenshot

Press to save the current image of camera to the phone's photo gallery

- Talk

Press it to talk through the Feeder. There have 2 modes for you to choose, "Two-way Talk" and "One -way Communication", you can change the it under '**Device settings**' -> '**Basic Function Settings**' -> '**Talk Mode**'

- Playback

Playback your record video on your SD card

- Schedule

Program time periods, cycle and portion to feed automatically. Timer tolerance may be about +/- 30 seconds. It supports up to 10 schedules can be set.

- Feed

Set portion to feed automatically via mobile phone.

- Alarm

Enable motion detection to get notification on your mobile when something move within the camera's field

NOTE: Only Android phones support "Photo album"!

5. FAQ:

How to install the 18650 battery:

Note: Both the battery and the battery box of 18650 need to be purchased separately

1. Get a battery box with 18650 battery, like figure 1.
2. Place the feeder horizontally in front of the body, then put the battery box into the battery slot according to the direction shown in the figure 2, and then push it forward to fix it.



Figure 1



Figure 2

How to remove and install the barrel:

- How to remove the barrel:

1. Please fix the white main body first, and then hold the black barrel with both hands and lift it up, then the barrel can be disassembled
2. Please wipe it clean with a clean damp cloth.



- How to install the barrel:

Please return the paddle in the barrel (as shown in the figure below), and then place the barrel on the main body according to the direction when it was removed and press it down gently to fix the barrel.

